

Col. Co., AR-10 Acres. 2-17S-20W. Woodward

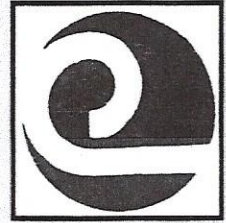

Additional Columbia County Plat Books and Wall Maps may be purchased from: Columbia County Conservation District Donald W. Reynolds Campus and Community Center, Room 102G 100 E. University, P.O. Box 9432 Magnolia, AR 71754 (870) 235-5270

TOWNSHIP 17S • RANGE 20W

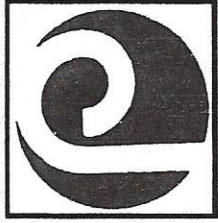
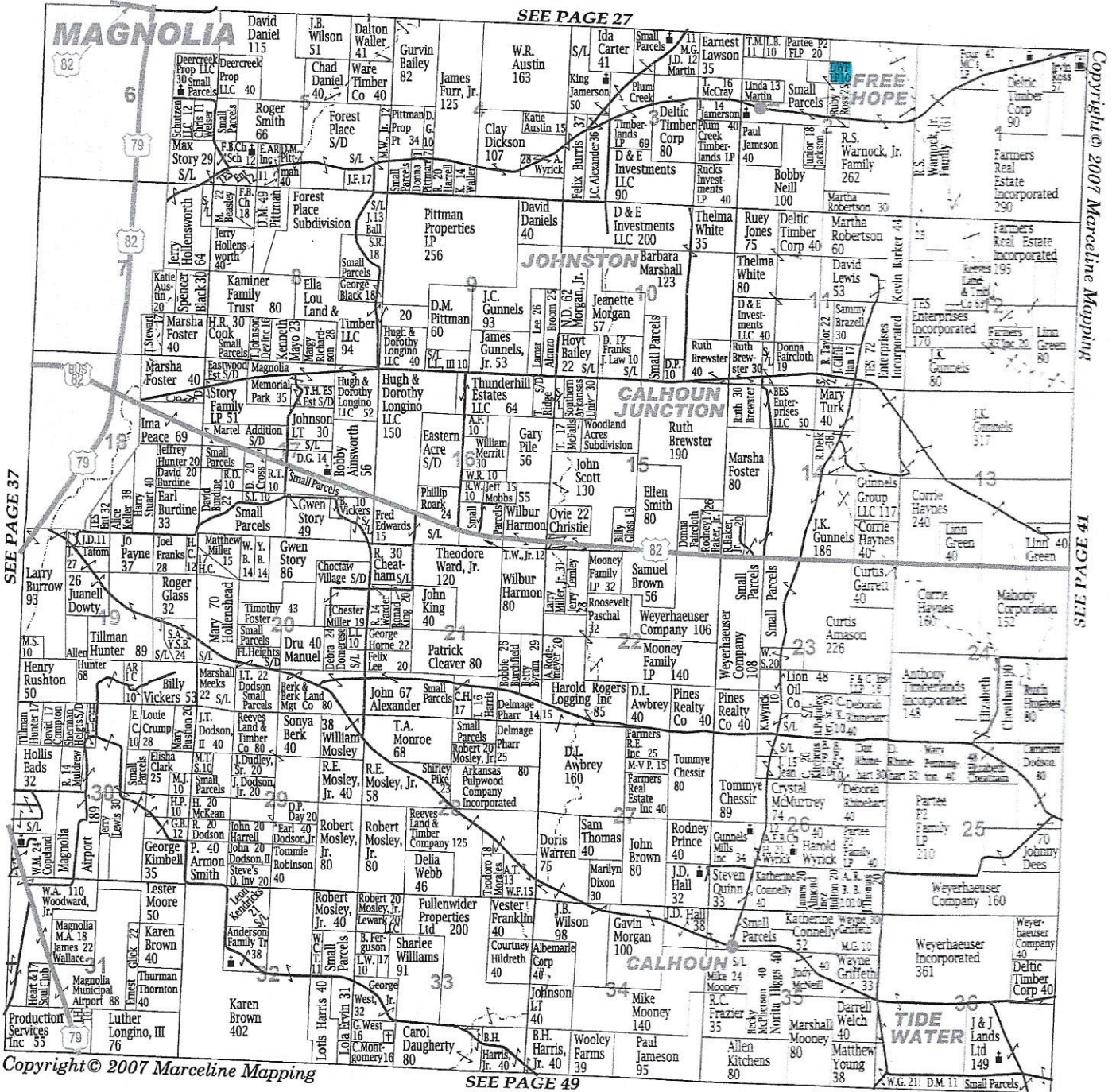

Copyright © 2007 Marceline Mapping

SEE PAGE 49